

Figured dimensions only are to be taken from this drawing as the graphics on photocopied / printed versions may be distorted. All dimensions are to be checked on site prior to any work commencing. Where applicable this drawing must be read with additional information prepared by Studio Heathfield Limited and/or others.

NOTES:

i) For specification and design of all structural elements refer to Structural Engineer's details and calculations.

ii) If any discrepancies are identified between the Architects and Structural Engineer's drawings, these are to be reported prior to undertaking construction work.

iii) These documents and drawings have been prepared on a partial service appointment only and are intended as a guide for the purposes of obtaining Building Regulations approval. It may therefore be necessary for further working drawings to be prepared for the construction works on site.

iv) Should the contractor wish to amend the details contained below he should agree these in writing with the Building Control Officer and formally advise the client before implementation.

v) Groundline is shown for indicative purposes only. All levels are subject to confirmation.

vi) Where shown, building tones (used for representing building materials), neighbouring buildings and vegetation (including trees and hedges) are shown for illustrative / site context purposes only and as such they are approximate representations only and consequently they may differ from the as-built solution.

vii) All floor finishes and furniture are indicated for illustrative purposes only and may vary as design is developed.

viii) Dimensions stated are subject to normally accepted industry construction tolerances.

KEY

- SVP = Soil & vent pipe
- RWP = Rainwater pipe
- AB = Air Brick
- FP = Fireplace
- EV = Extract Ventilation
- DS = Door Stop

LEGEND

- SD = Automatic Linked Smoke Detector (mains operated with battery back-up)
- HD = Automatic Linked Heat Detector. Unit to be suitable for a Kitchen or similar location.

FD30S VP = 30min fire-resisting self-closing door to escape routes with vision panel. Frame fitted with smoke seals.

FD20 = 20min fire-resisting door and frame.

A Updated for Tender Issue 11/05/15
Mark Revision Date

studio
heathfield

parallel house 32 london road guildford gu1 2ab
telephone 01483 230760 www.studioheathfield.com

Client's name
Clarence Estates
(Kingston On Thames) Ltd.

Job title
6A High Street, Esher, Surrey

Drawing title

Floor Plans - Proposed GA
Internal Refurbishment Works

Scale
0m 0.5m 1.0m 1.5m

1:25 @ A1 / 1:50 @ A3

Job No Drawing No Rev Date

15-04 GA02 A Apr15

Status

FOR TENDER

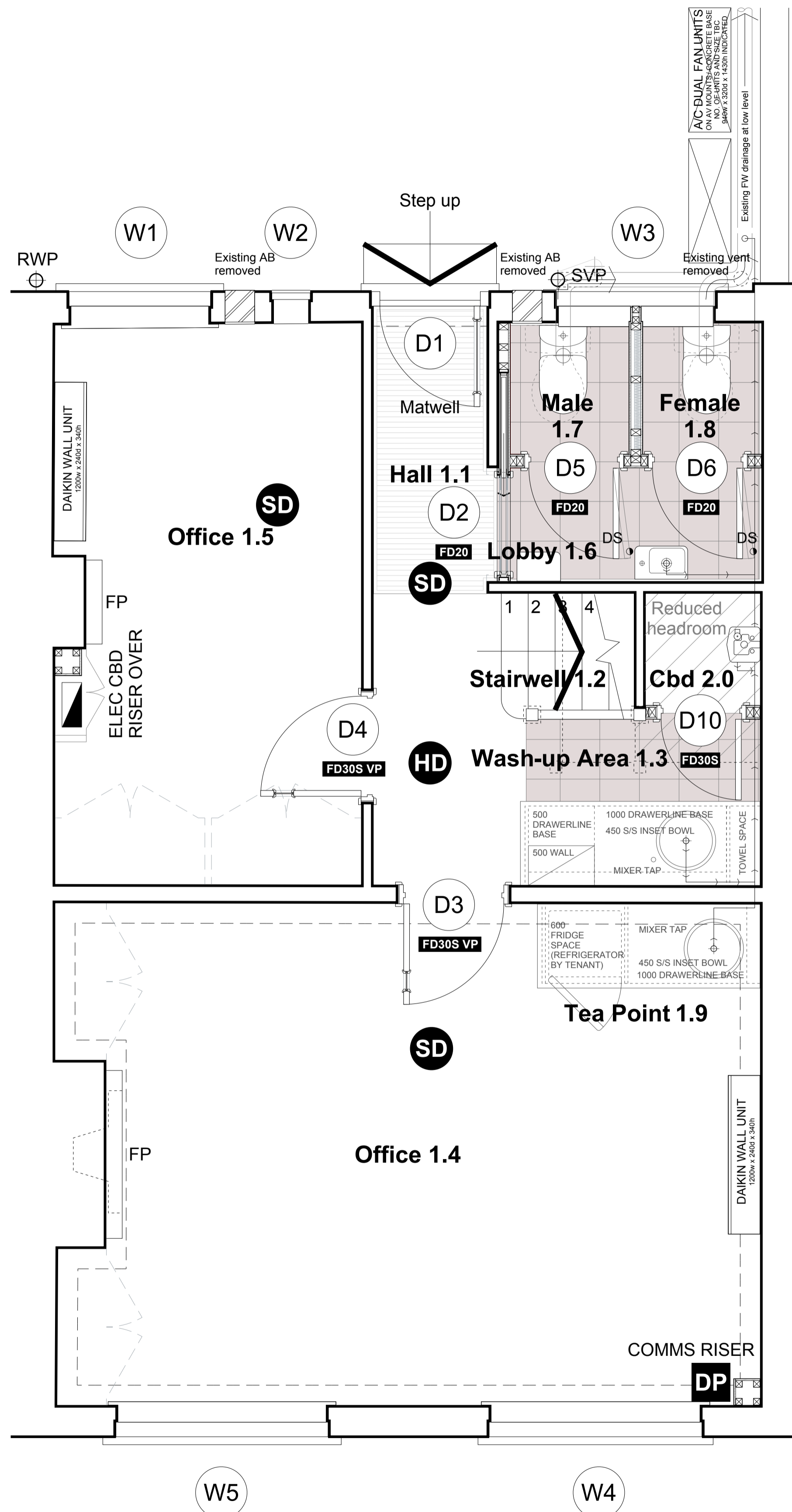

Ground Floor Plan - Proposed

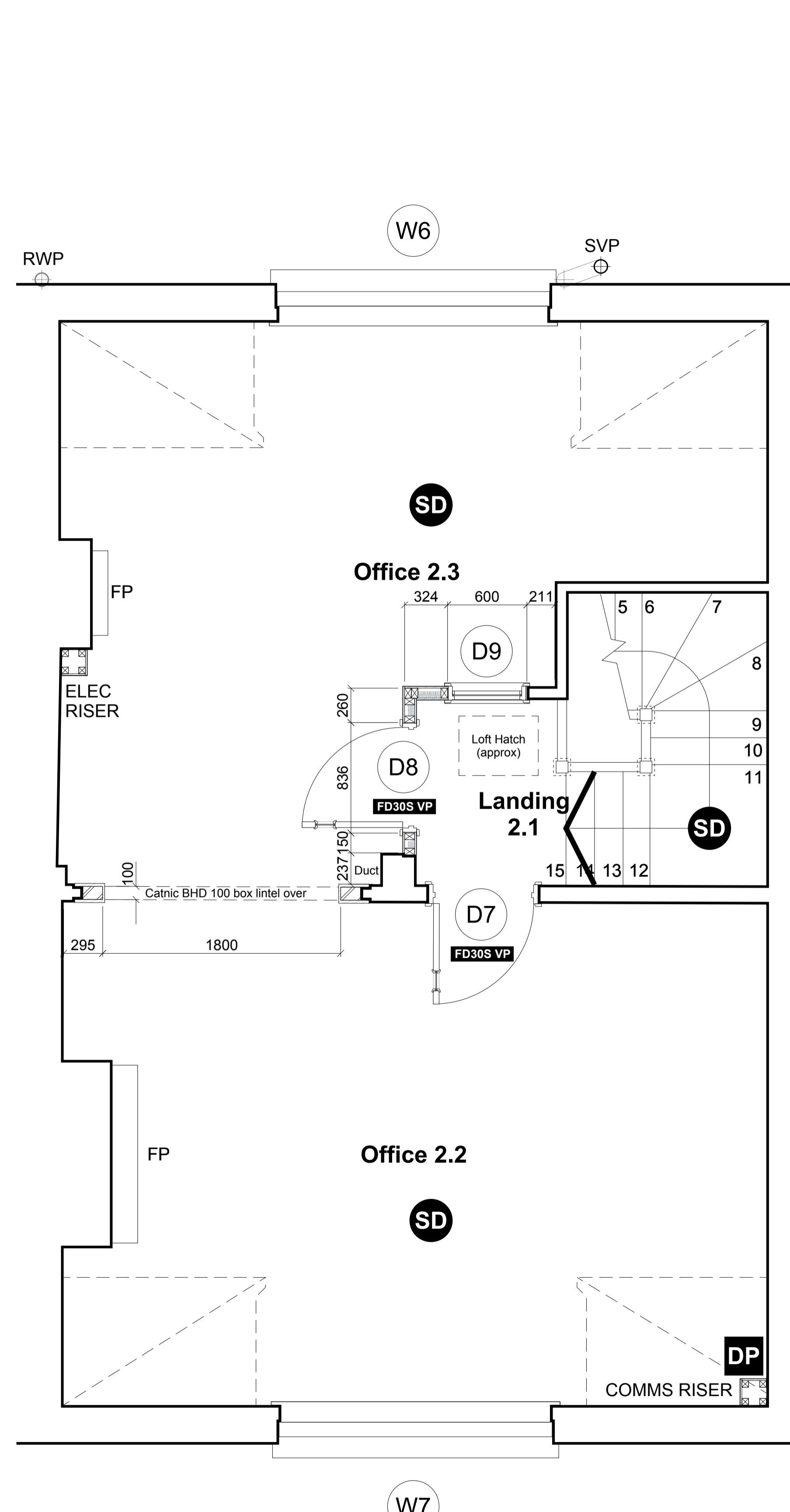

First Floor Plan - Proposed